

The 12 V / 140 A battery coupler is designed to recharge two lead batteries simultaneously. It is ideal for recreational vehicles (motorhomes, boats, etc) as it allows a reciprocal, rapid, and reliable recharge of the starter battery and auxiliary battery (service battery). Compact and easy to install, it can be fitted as close as possible to the starter battery to ensure the best possible performance.

FLOW MANAGEMENT FOR LEAD-ACID BATTERIES

- ON** When one of the batteries reaches a voltage exceeding **13.3 V**, the coupler automatically engages, allowing the other battery to be charged simultaneously.
- OFF** If the voltage of the two batteries falls below **12.8 V**, the coupler disengages to protect the batteries from potential discharge.

140 A FOR COMPLETE BATTERY CHARGING

The 140 A continuous current (160 A peak current) delivered by the coupler means you can benefit fully from the performance of the «high power» alternators used in recreational vehicles. Both batteries are fully charged very quickly.

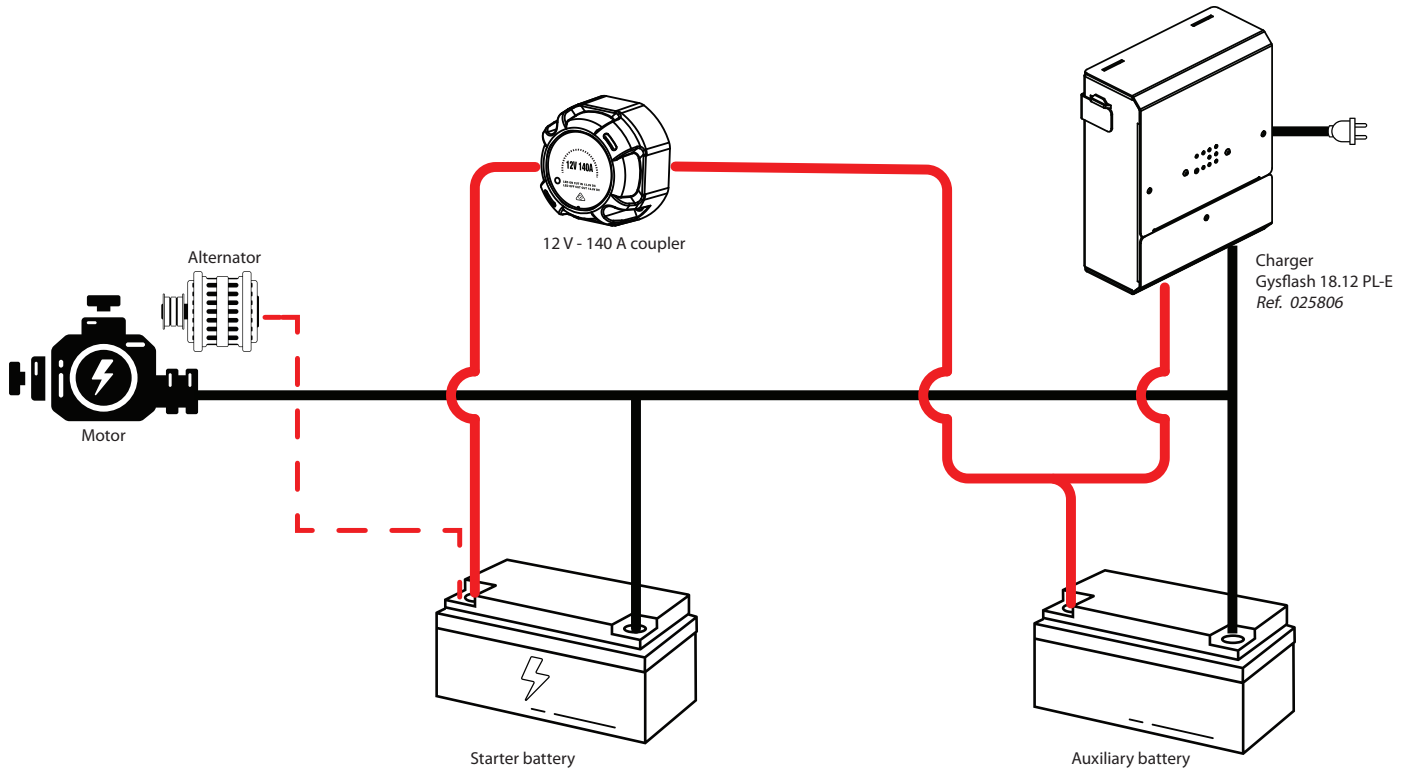

TECHNICAL DATA

Direct current	140 A
Max. current	160 A
Power consumption during use	140 mA
Power consumption on standby	100 uA
Dimensions	82 X 82 X 51 mm
Weight	230 g